

Fitting instructions

Make: Renault

Megane Long Scenic; 2004->

Type: 4521

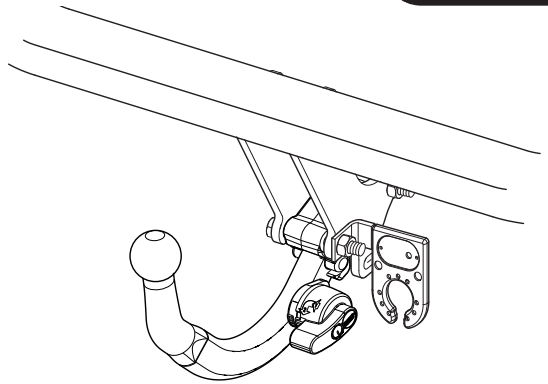

- NL Montagehandleiding
- GB Fitting instructions
- D Montageanleitung
- F Instructions de montage
- S Monteringsanvisningar
- DK Montagevejledning
- E Instrucciones de montaje
- I Istruzioni per il montaggio
- PL Instrukcja montażu
- SF Asennusohjeet
- CZ Pokyny k montáži
- H Szerelési útmutató
- RUS Руководство для монтажа

BRiNK®

Your perfect fit
brink.eu

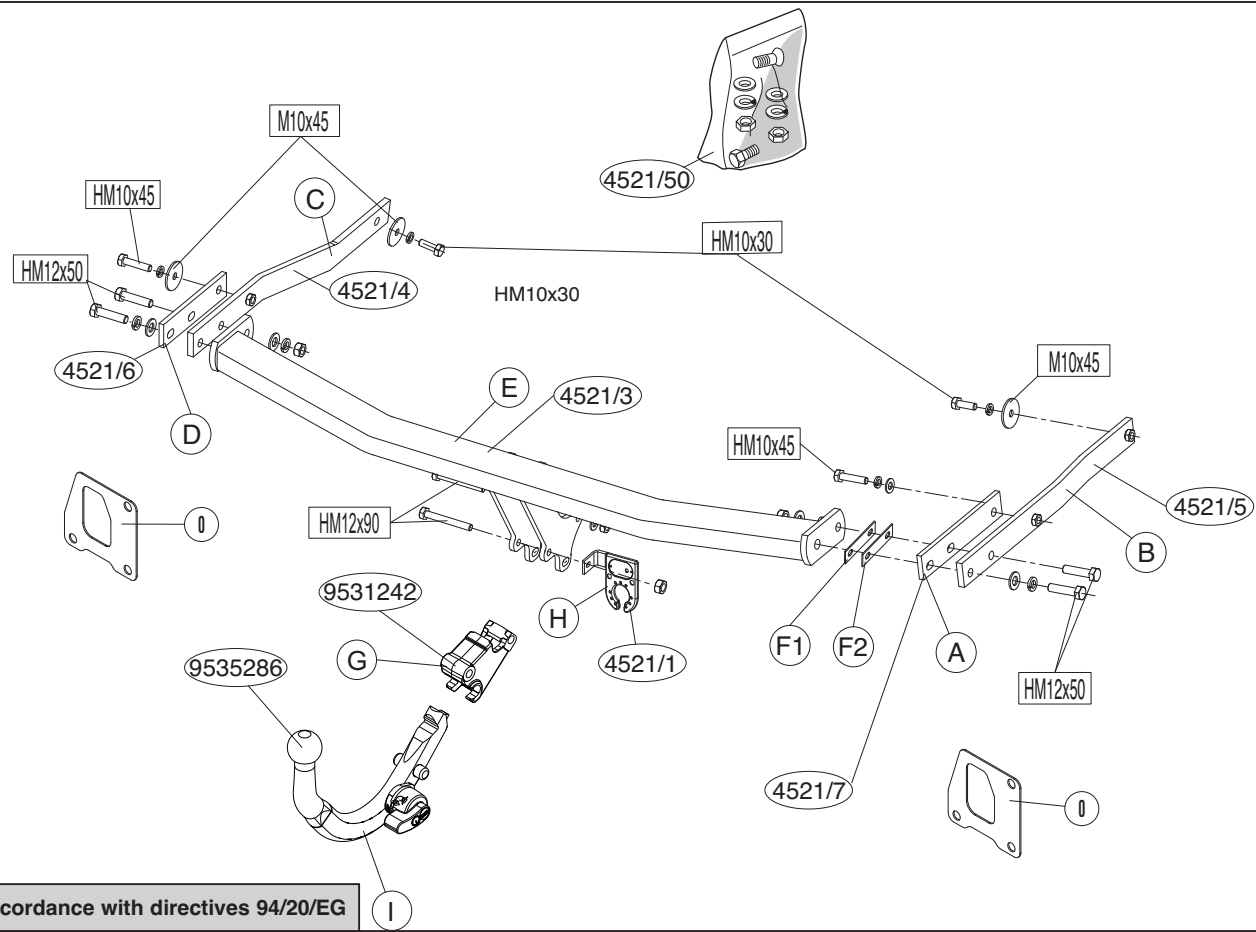

Tested in accordance with directives 94/20/EG

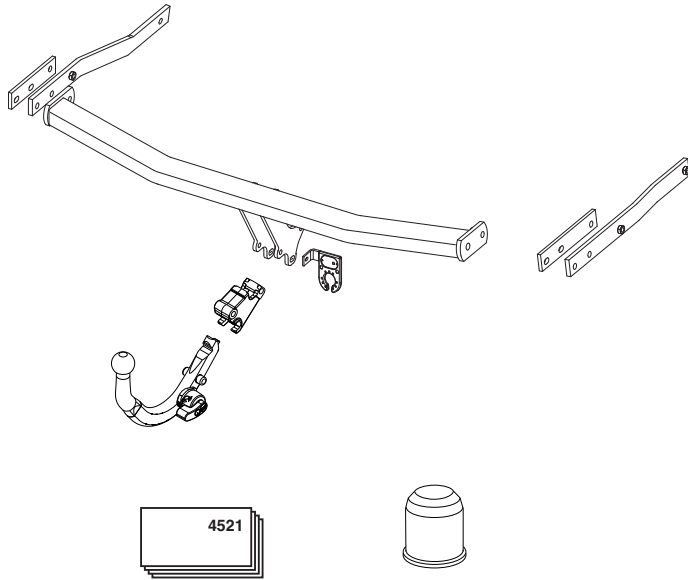
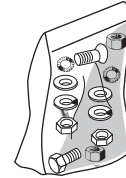
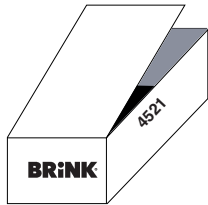

- (2x) HM6x20 (8.8)
- (2x) HM10x30 (8.8)
- (2x) HM10x45 (8.8)
- (2x) HM12x80 (8.8)
- (4x) HM12x50 (8.8)
- (2x) M6
- (4x) M10
- (4x) M12
- (6x) M12
- (4x) M10x45
- (2x) M6
- (2x) M12
- (2x) M12 (self-locking)
- (2x)
- F1= 1mm
- F2= 2mm

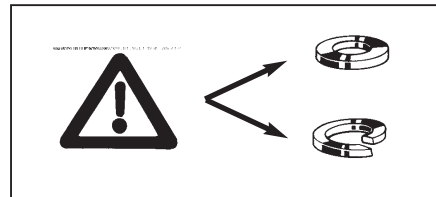
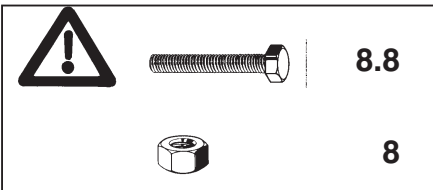
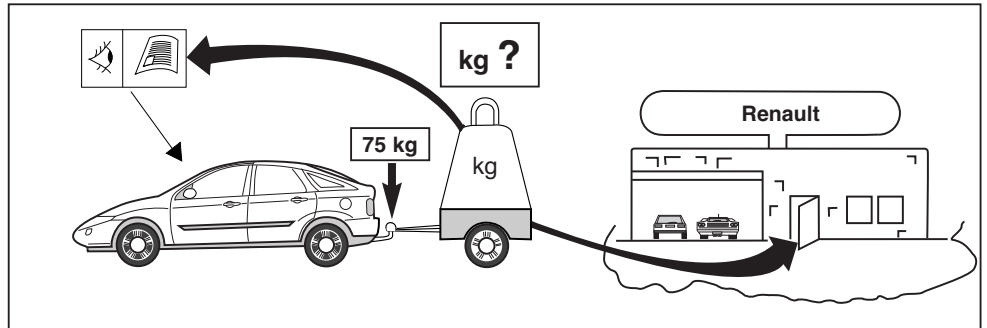
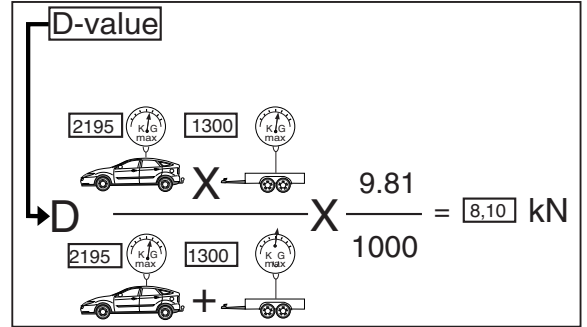
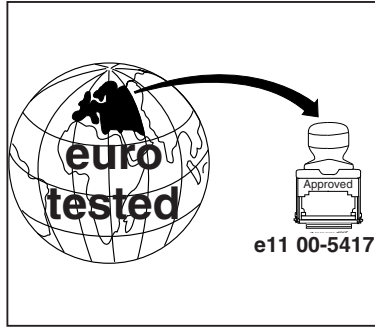
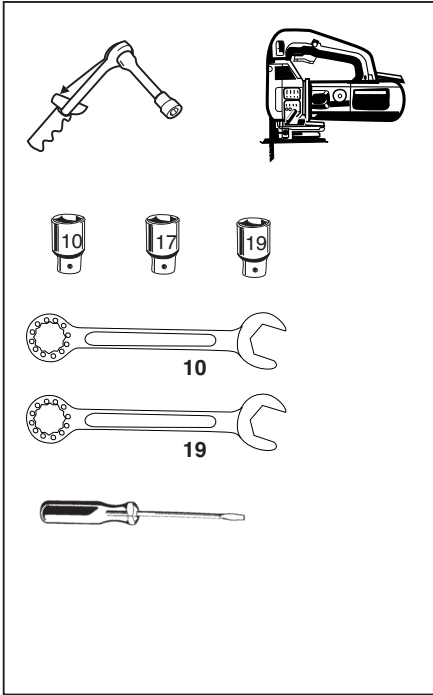



Torque settings for nuts and bolts (8.8)

M 6



9,5 Nm

M10



46 Nm

M12



79 Nm 71 Nm (self-locking)

HINWEISE:

* Die für das Fahrzeug zugelassene Anhängelast ist den Fahrzeug Unterlagen zu entnehmen. Bei Änderungen des Fahrzeuggewichtes muß die höchstzulässige Anhängelast gegebenenfalls aus dem D-Wert nachgerechnet werden.

Auskunft hierüber kann Ihr Fachhändler oder der TÜV geben.

* Elektrische Anlage gemäß StVZO anbringen.

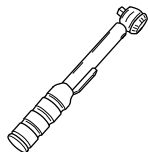

0km



+

1000km



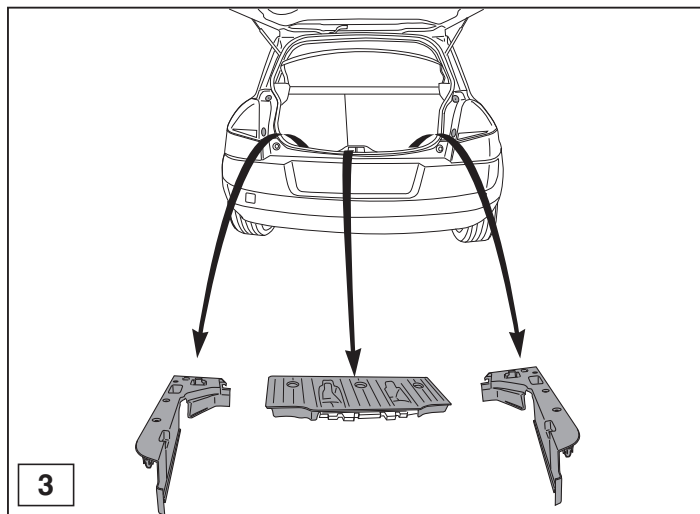
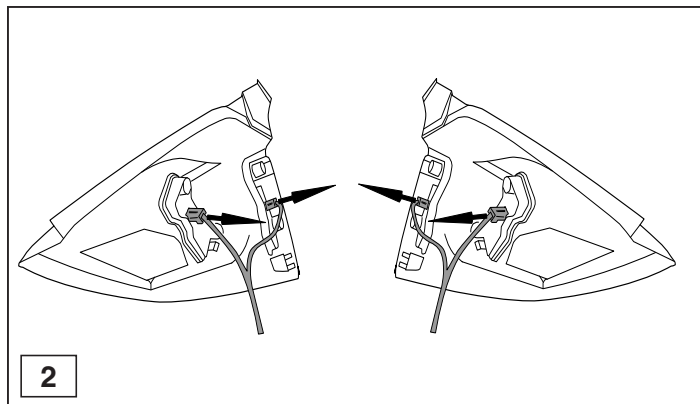
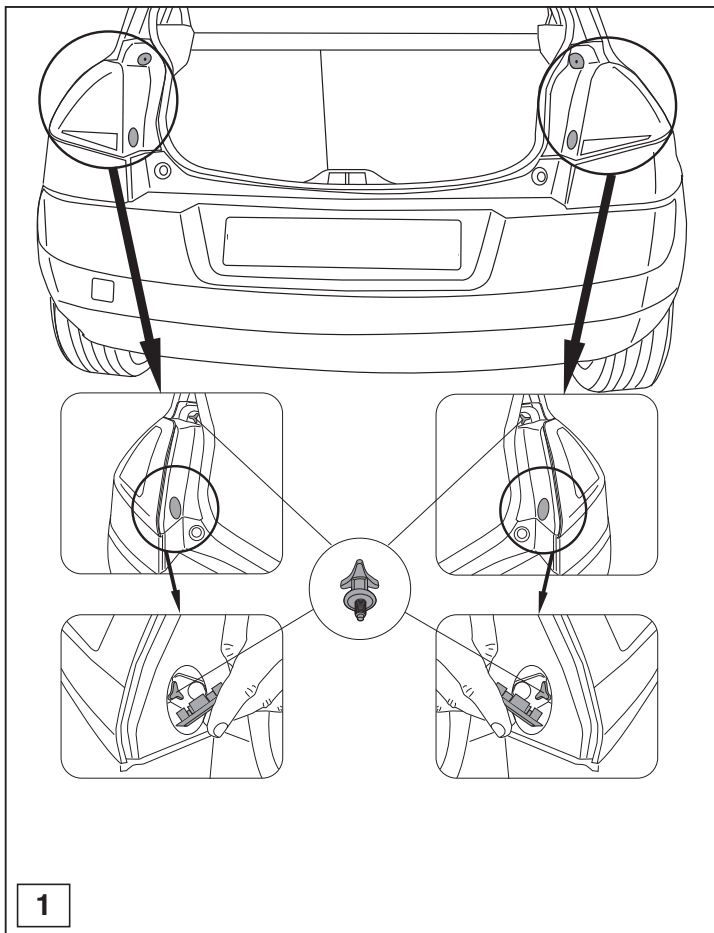

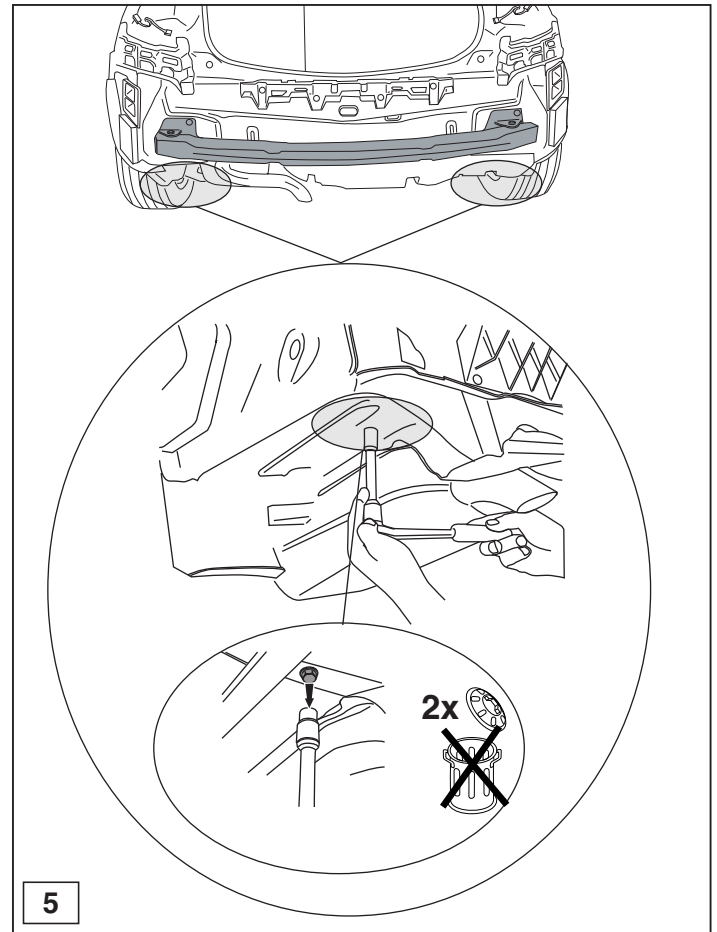
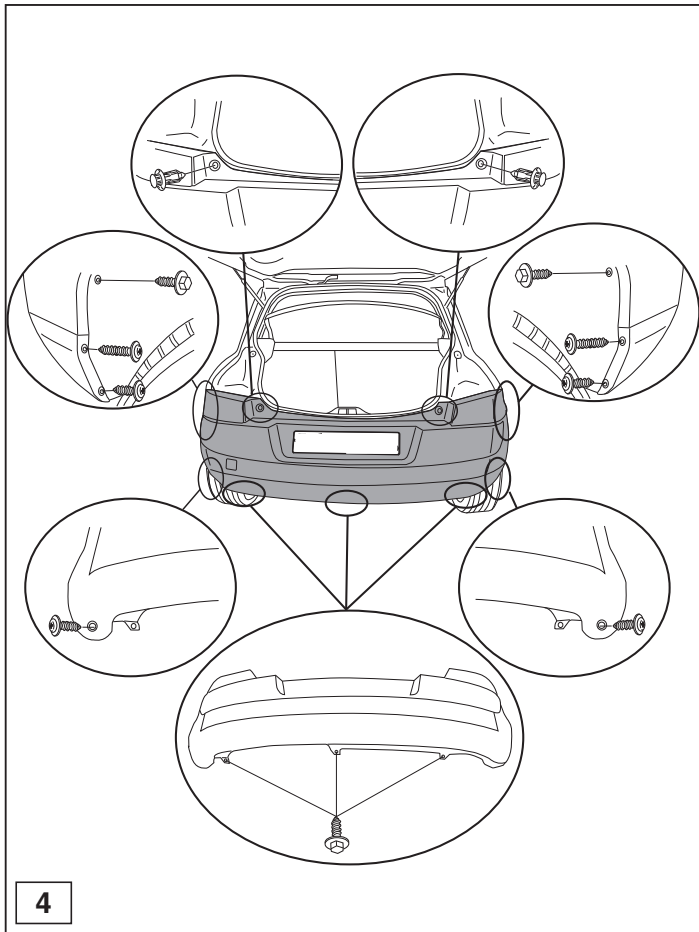

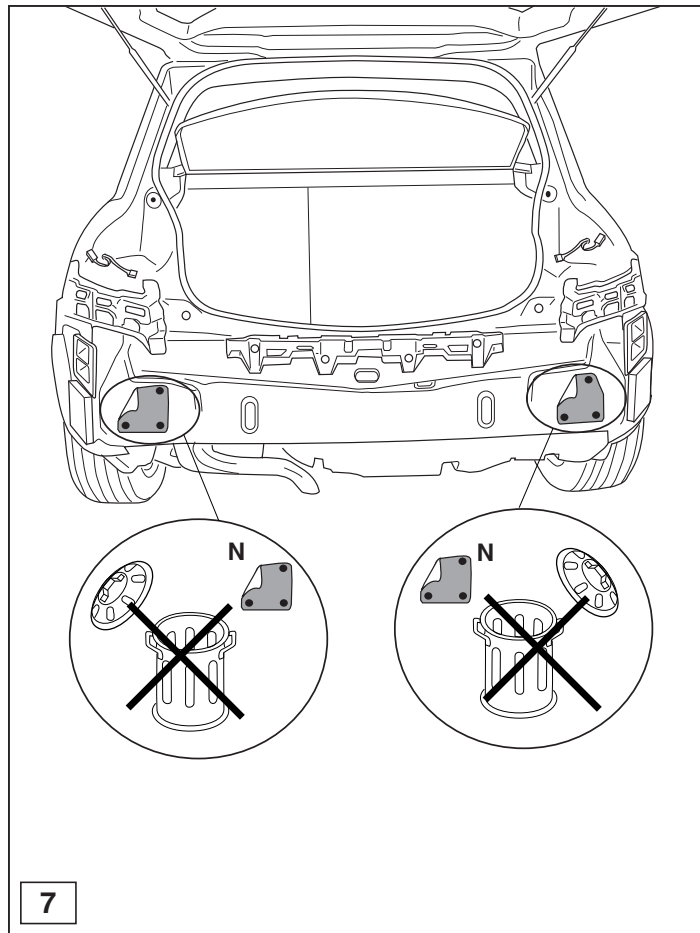
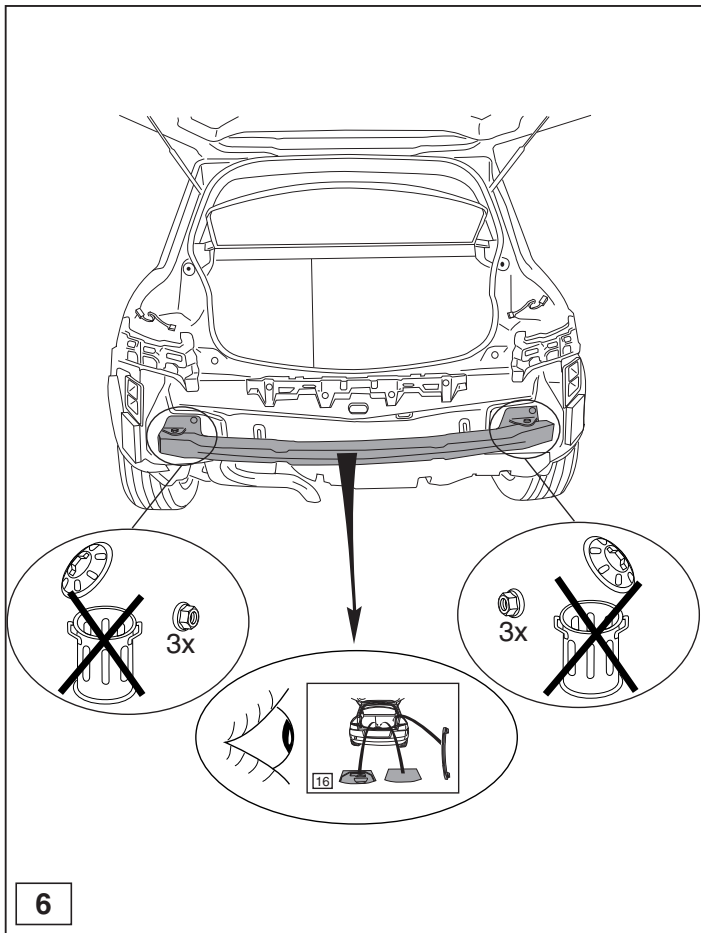

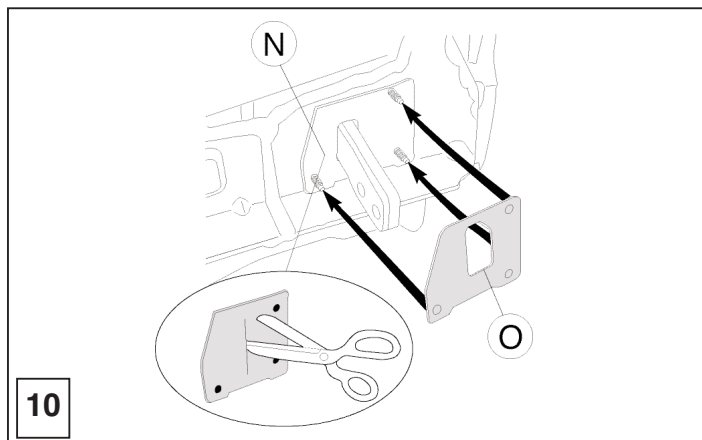
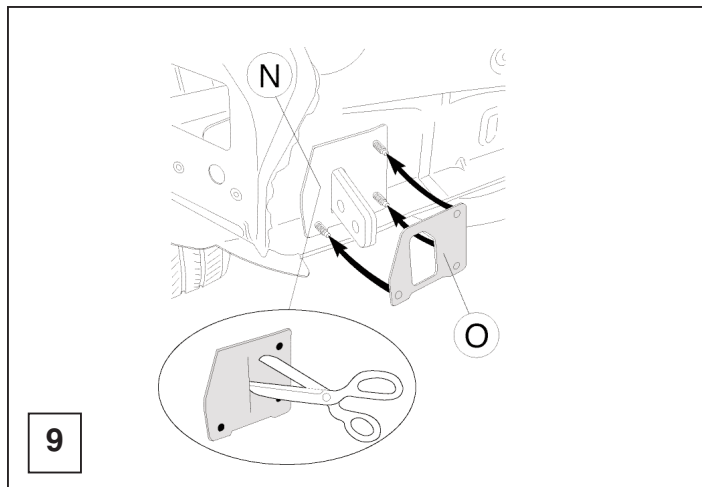
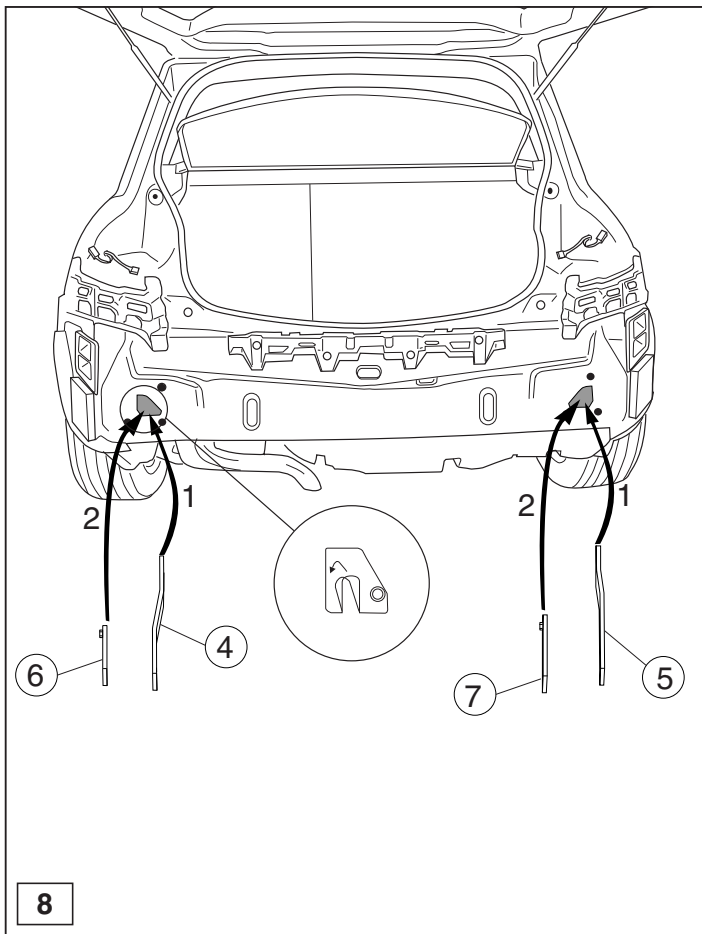

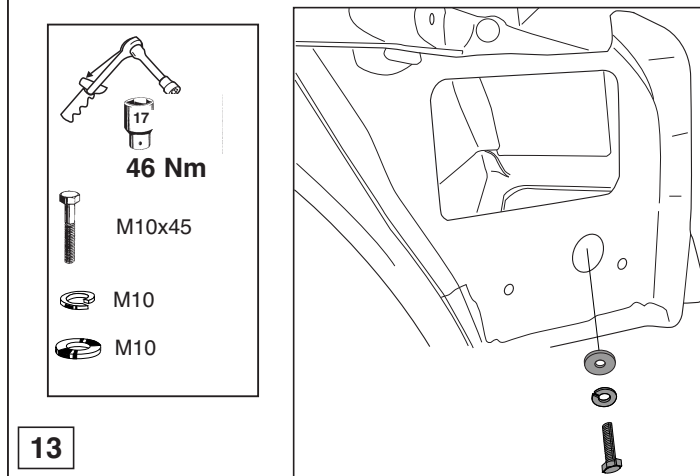
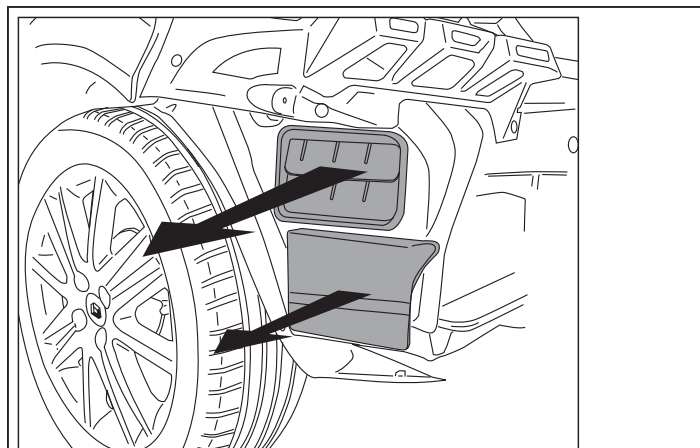
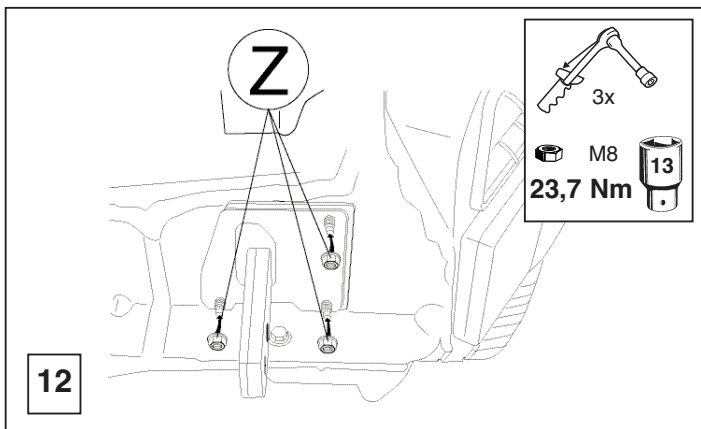
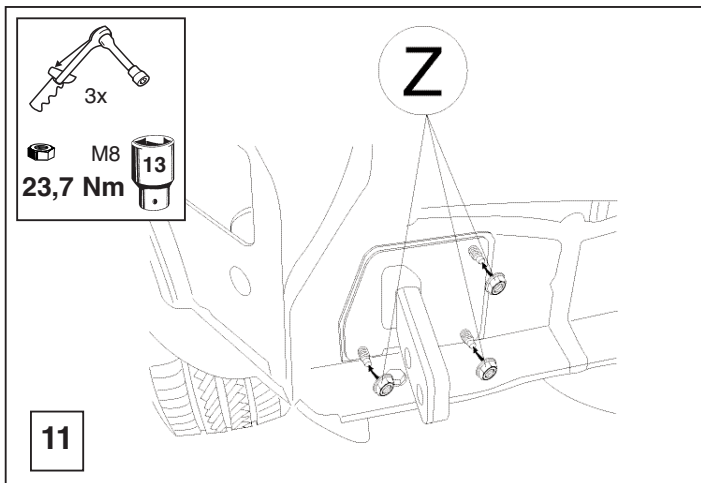

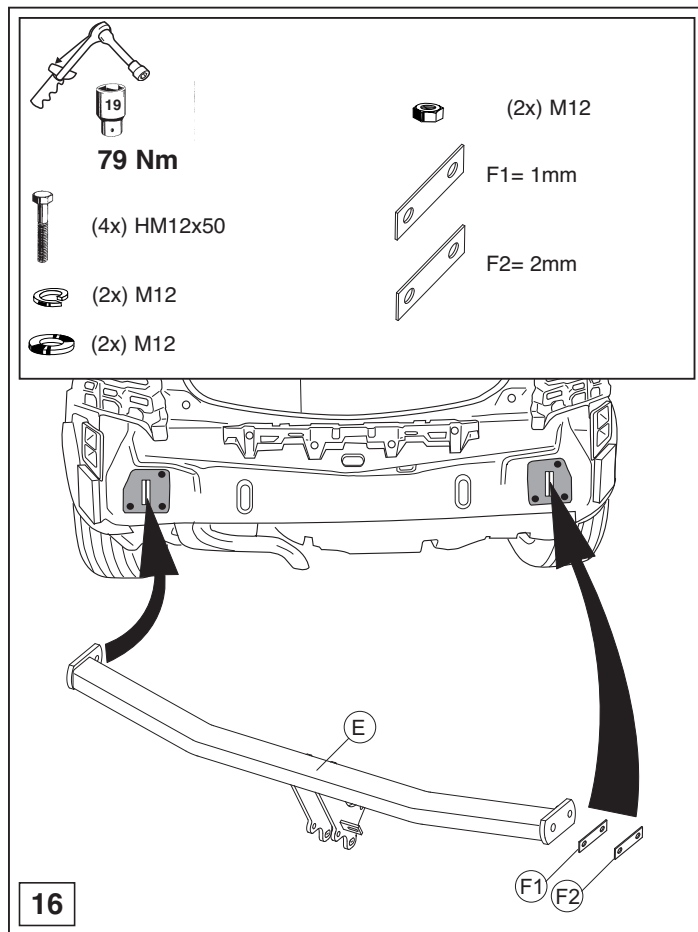
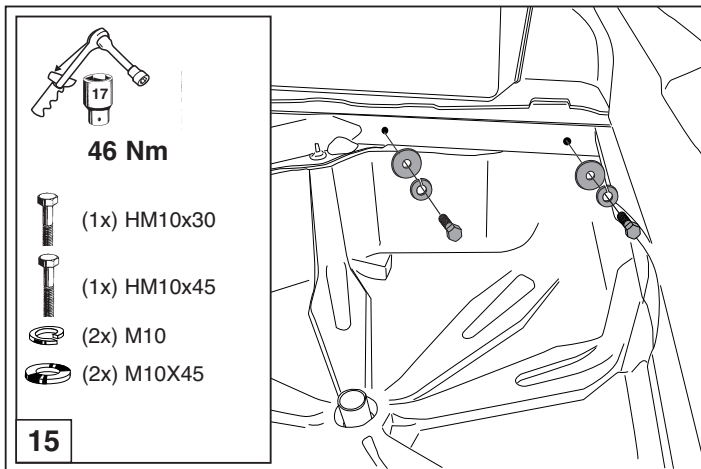
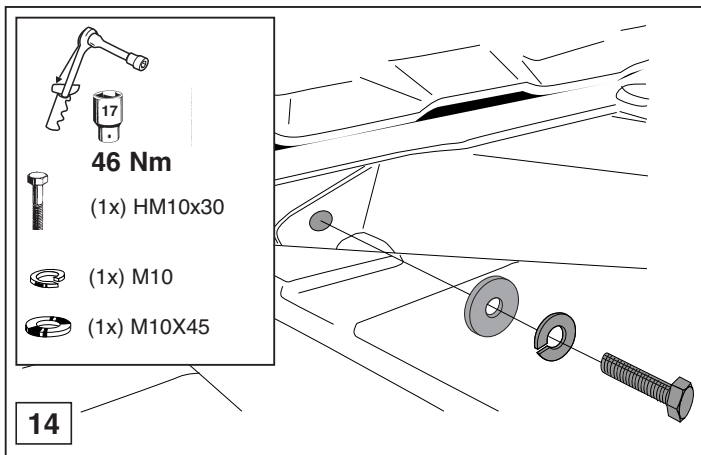

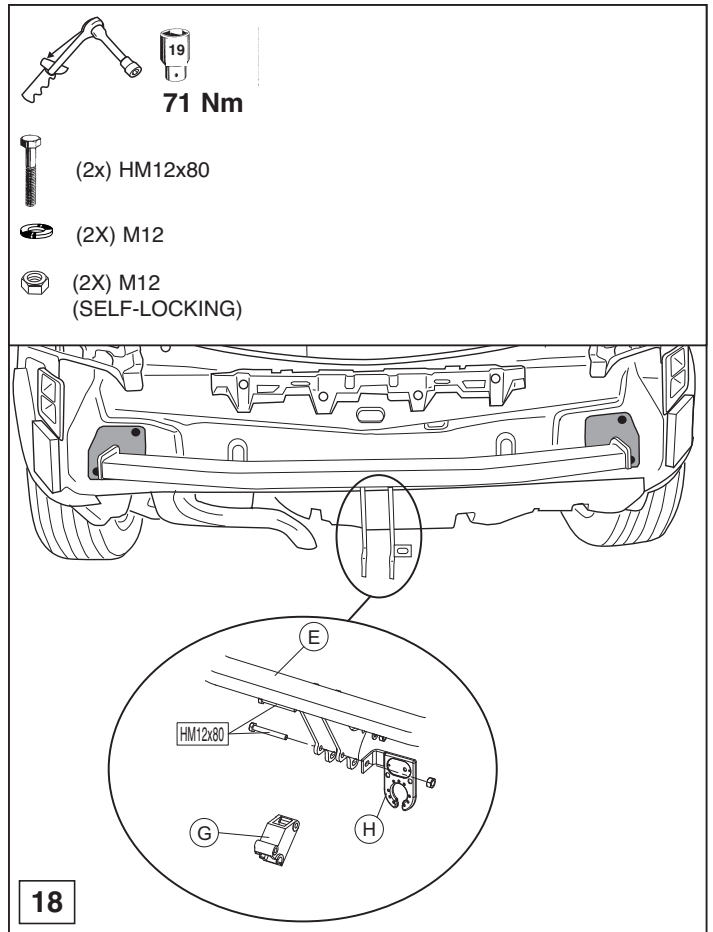
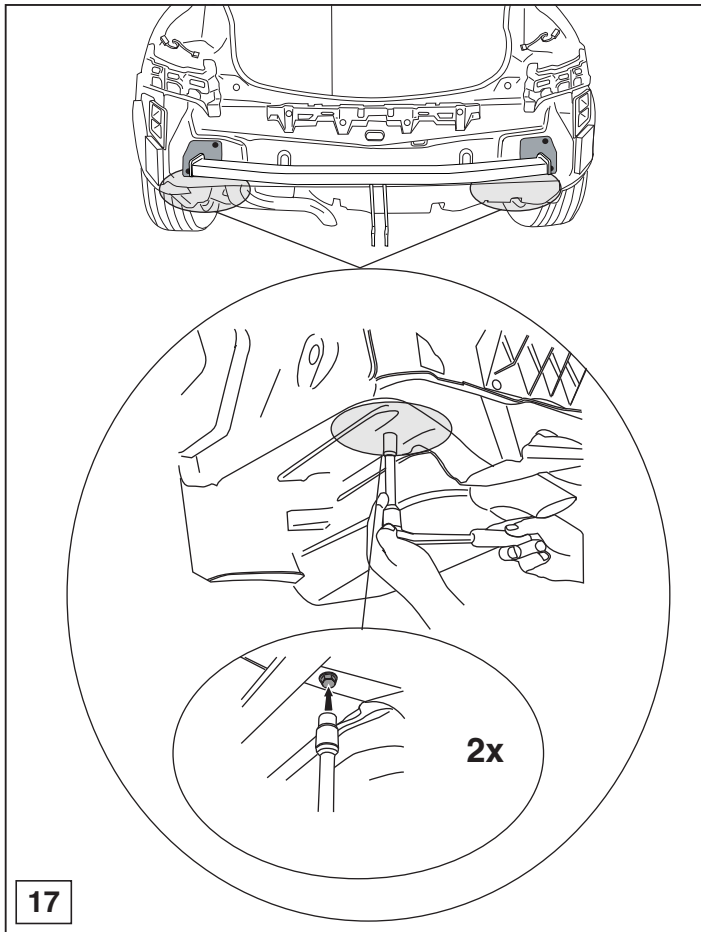

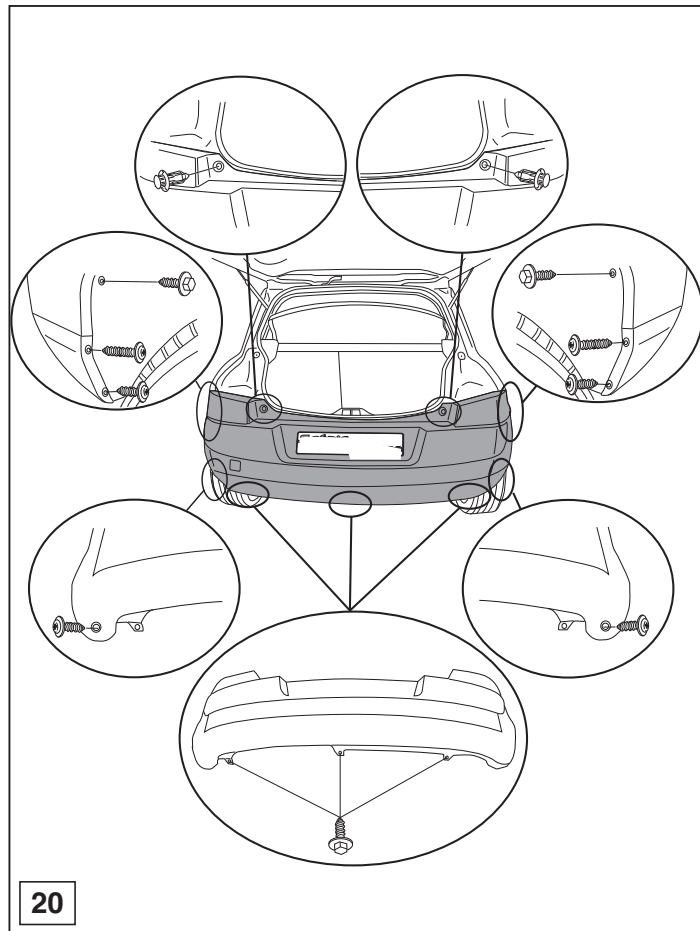
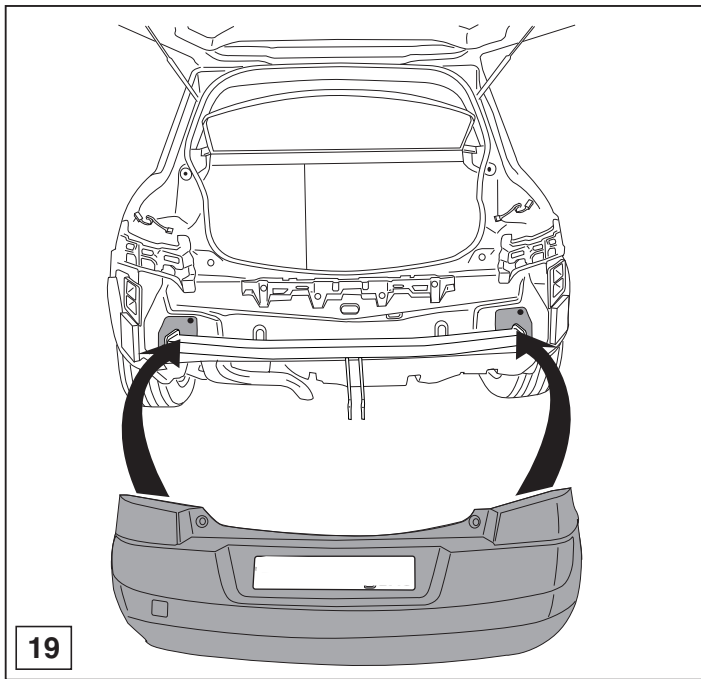

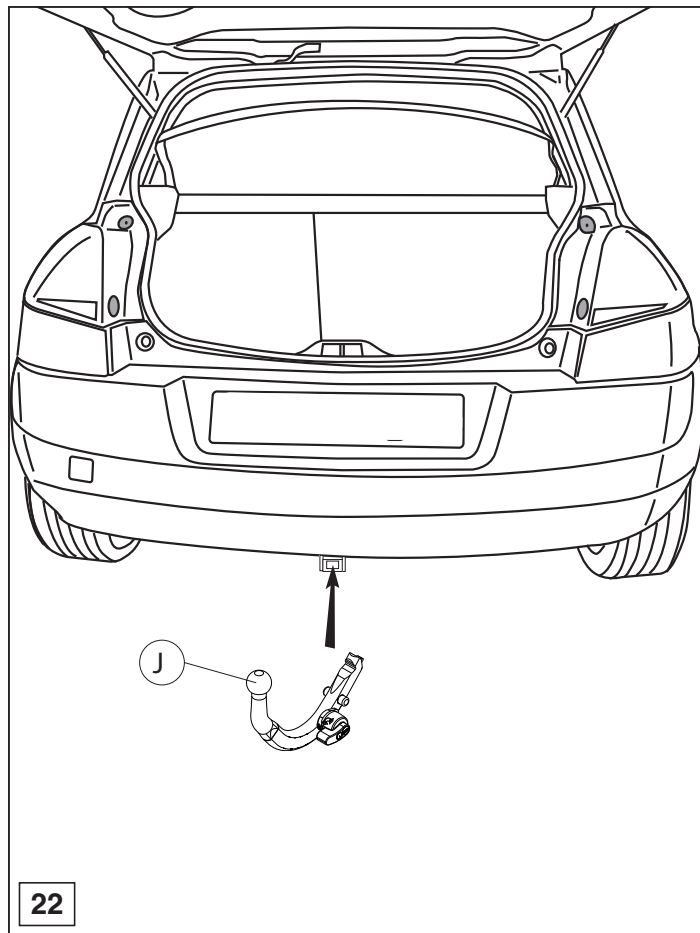
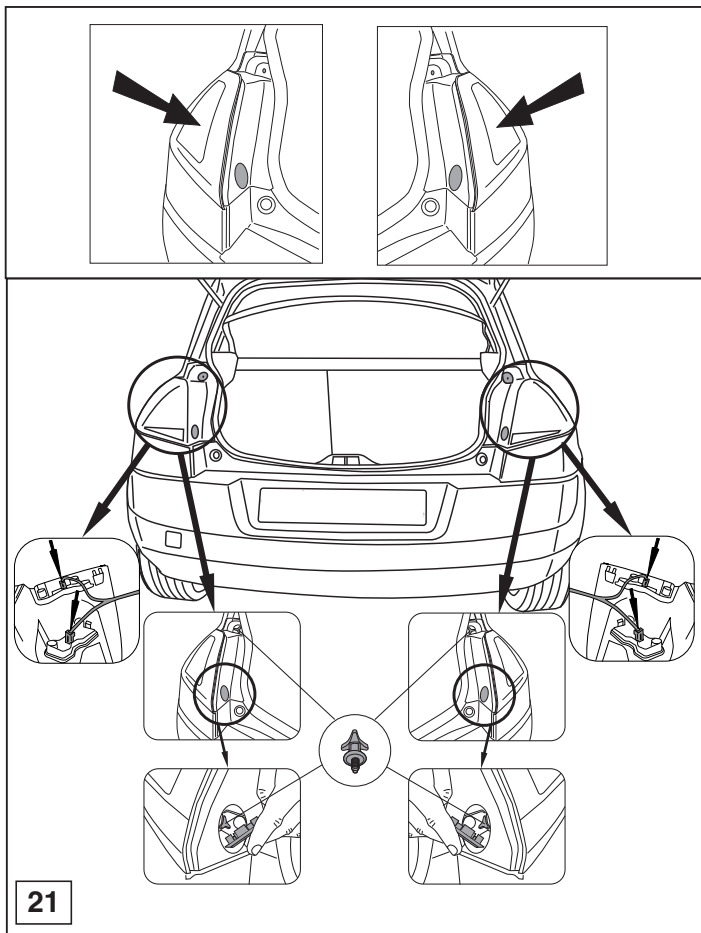

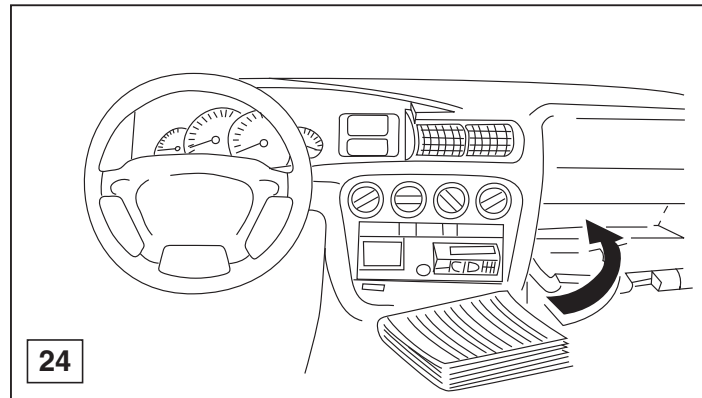
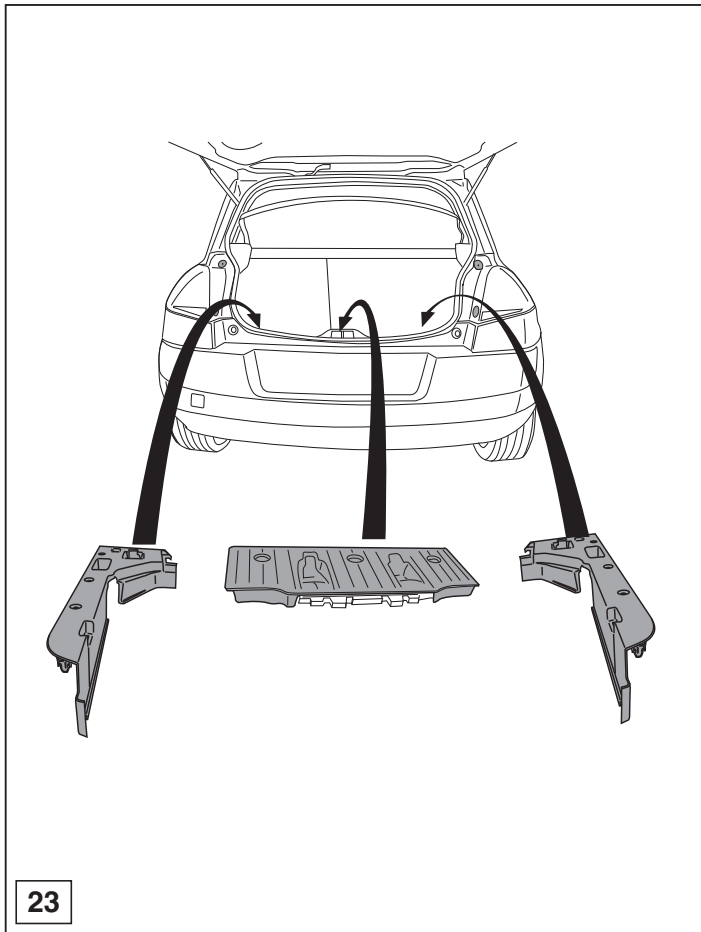

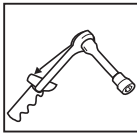

(4x) M10

46 Nm (8.8)



(2x) M12

71 Nm
self-locking



(4x) M12

79 Nm (8.8)





Dispositivo di traino tipo: Brink 4521
Per autoveicoli: Renault Scenic II; 2002-> / Megane II; 2003-> / Megane Long Scenic; 2004->
Tipo funzionale:

Classe e tipo di attacco: A50-X
Omologazione: e11 00-5417
Valore D: 8,10 kN
Carico Verticale max. S: 75 kg
Larghezza rimorchiabile per Caravan e T.A.T.S.: 2,45m vedere CARTA di CIRCOLAZIONE VEICOLO (motrice) + 70 cm = ..arrotondare ai 5 cm superiore (vedi D.M.28/05/85)
Massa rimorchiabile: vedi carta di circolazione dell' autoveicolo

Per verificare l'idoneità del dispositivo di traino omologato a norma CEE 94/20, all'installazione sulla vettura su cui si intende procedere al montaggio, compilare la seguente formula (se necessario declassare la massa rimorchiabile):

$$D = \frac{T \times C}{T + C} \times 0,00981 = \dots\dots \text{kN}$$

dove: T= Massa Complessiva Max. della motrice (in kg)
C= Massa Rimorchiabile Max. della motrice (in kg)

DA COMPILARE PER IL COLLAUDO

DICHIARAZIONE DI CORRETTO MONTAGGIO: la sottoscritta Ditta dichiara di aver montato in maniera corretta ed in conformità/ alle prescrizioni sia del costruttore del veicolo che del costruttore del dispositivo stesso il seguente dispositivo di attacco meccanico:

tipo:.....
Il dispositivo di attacco sopra indicato è stato installato su autoveicolo
modello:.....
targa:.....
Data:.....

TIMBRO e FIRMA

Si dichiara inoltre di aver informato l'utente del veicolo sull'USO e MANUTENZIONE del dispositivo stesso.

