

**Notice de pose du faisceau électrique pour  
crochet d'attelage avec prise 7 voies type 12N**

**Version : 5 DOORS**

**Année : 04/2009 →**

**Réf : 176543**

**C3 PICASSO**



**0 H 45**

Einbauanleitung elektrosatz Anhängervorrichtung mit 12N Steckdose  
Fitting instructions electric wiringkit towbar with 12N socket  
Montage-handleiding elektrokabelset voor trekhaak met 12N contactos

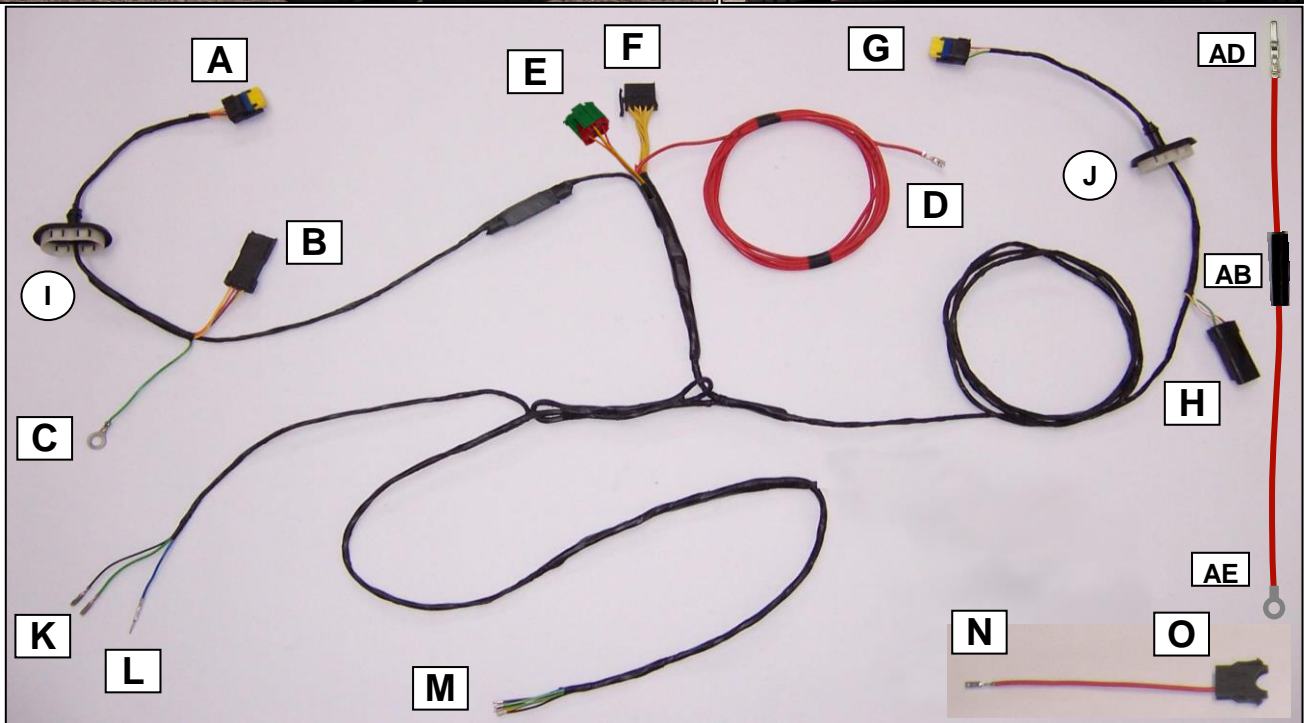
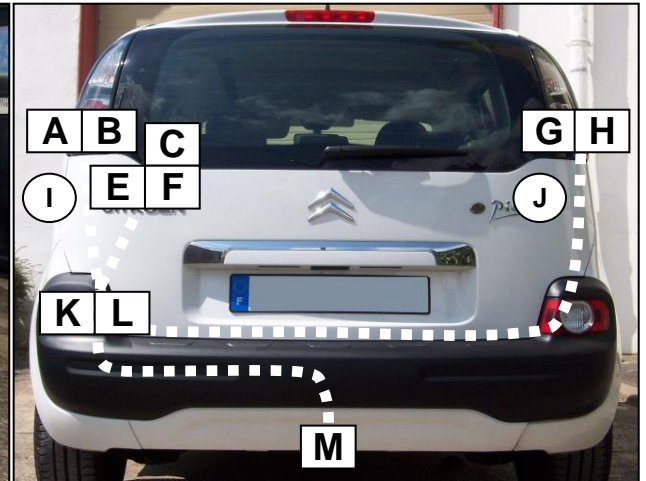

**Liste des pièces / Teilliste / Part list / Onderdelenlijst :**

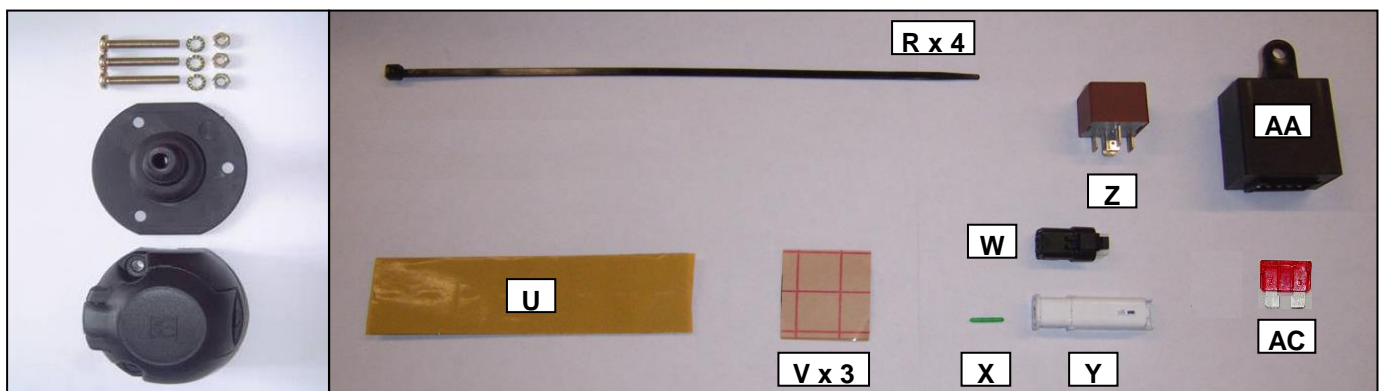

Cette notice ne peut être divulguée ou reproduite, partiellement ou en totalité, sans accord de la société.

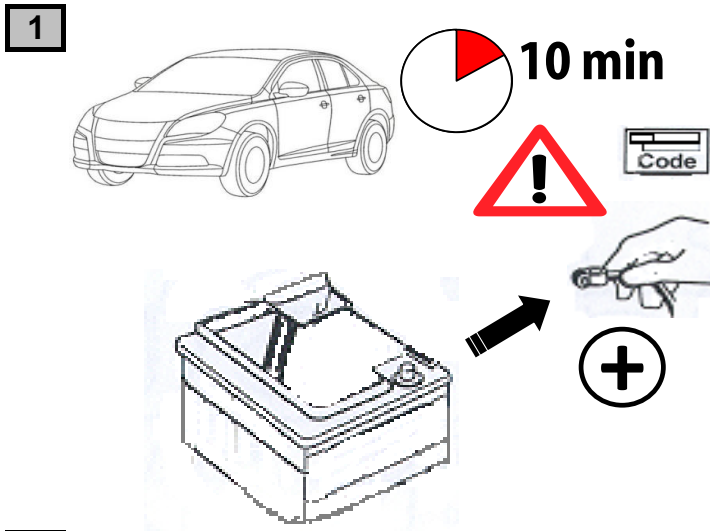

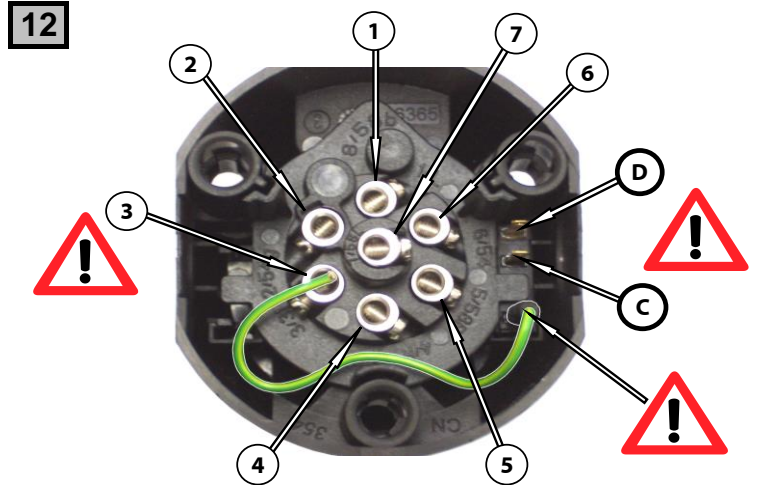
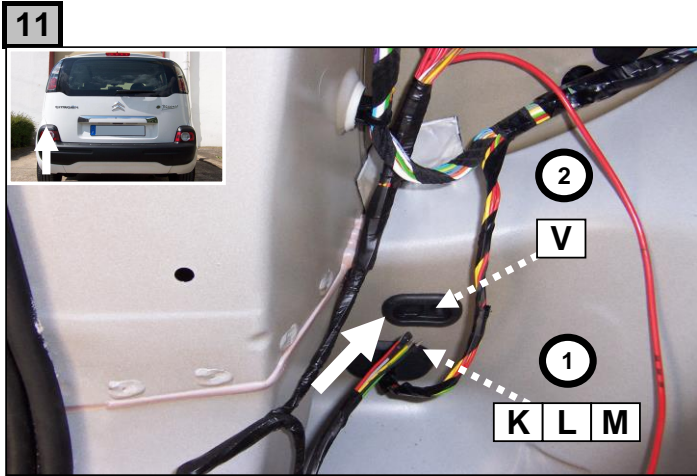
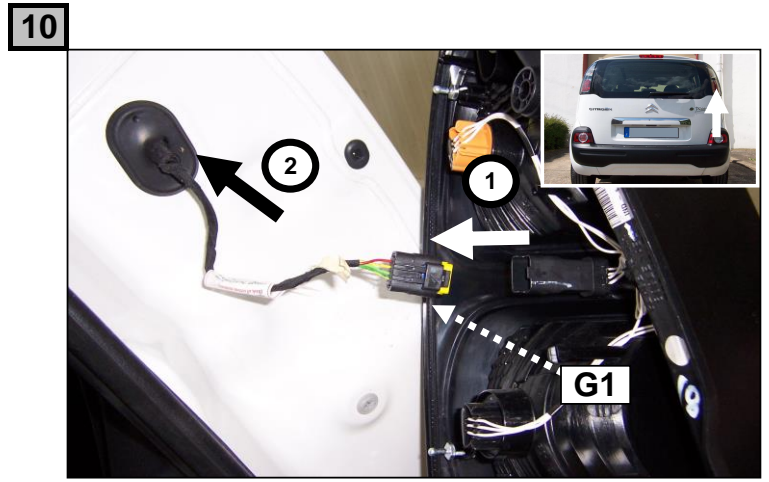
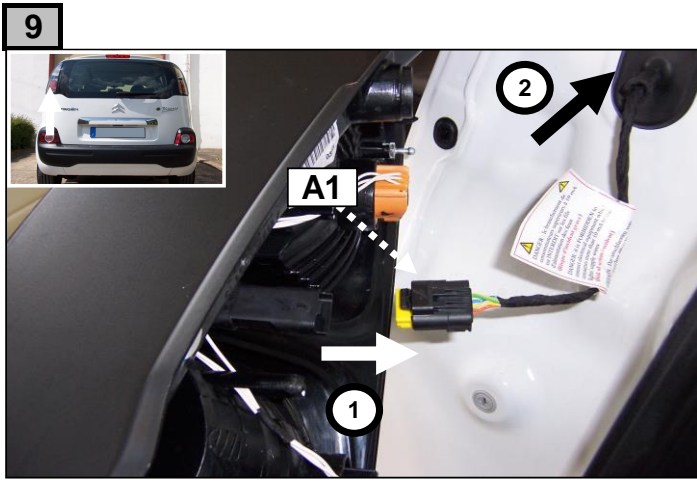

	<b>1/L</b>	<b>2/54g</b>	<b>3/31</b>	<b>4/R</b>	<b>5/58R</b>	<b>6/54</b>	<b>7/58L</b>	<b>(C)</b>	<b>(D)</b>
	21+5 W	21W		21+5 W	40 W	63 W	40 W		
<b>F</b>	Jaune	Bleu	Vert/jaune	Vert	Marron	Rouge	Noir	Gris	Beige
<b>D</b>	Gelb	Blau	Grün/gelb	Grün	Braun	Rot	Schwarz	Grau	Beige
<b>GB</b>	Yellow	Blue	Green/yellow	Green	Brown	Red	Black	Grey	Beige
<b>NL</b>	Geel	Blauw	Groen/geel	Groen	Bruin	Rood	Zwart	Grijs	Beige
<b>P</b>	Amarelo	Azul	Verde/amarelo	Verde	Castanho	Vermelho	Preto	Cinzeno	Beige
<b>I</b>	Giallo	Blu	Verde/giallo	Verde	Marrone	Rosso	Nero	Grigio	Beige
<b>E</b>	Amarillo	Azul	Verde/amarillo	Verde	Marron	Rojo	Negro	Gris	Beige

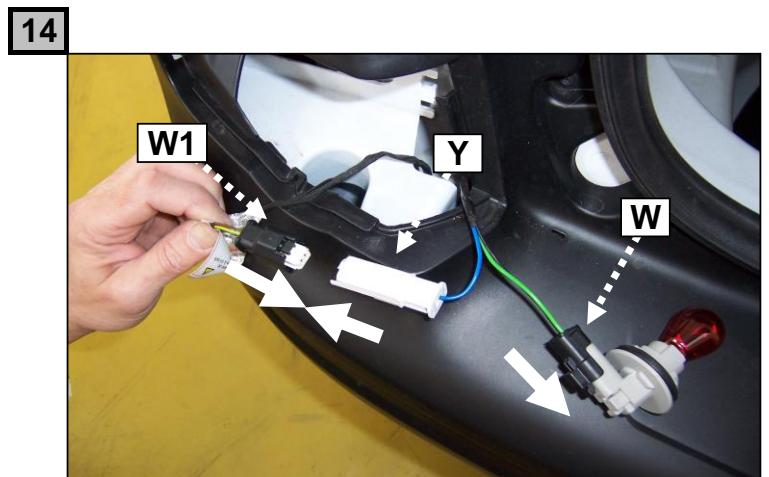
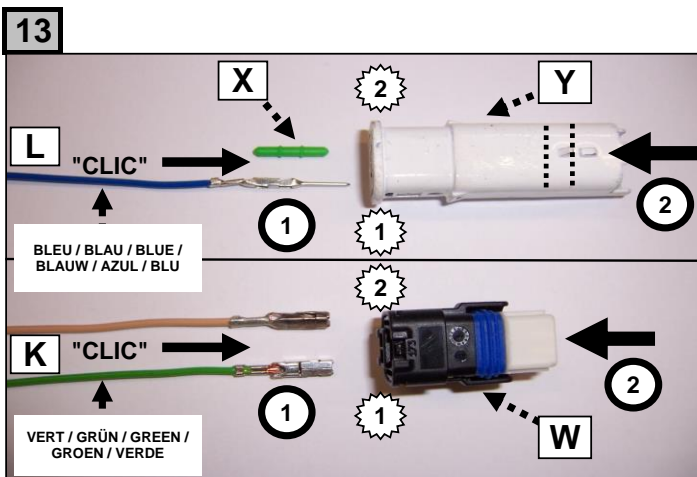

15

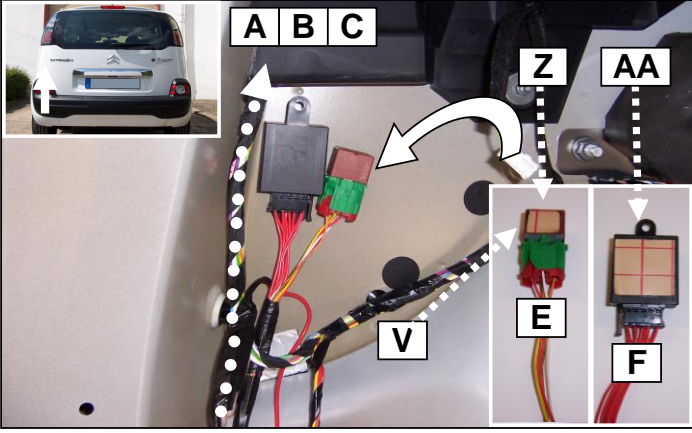

16

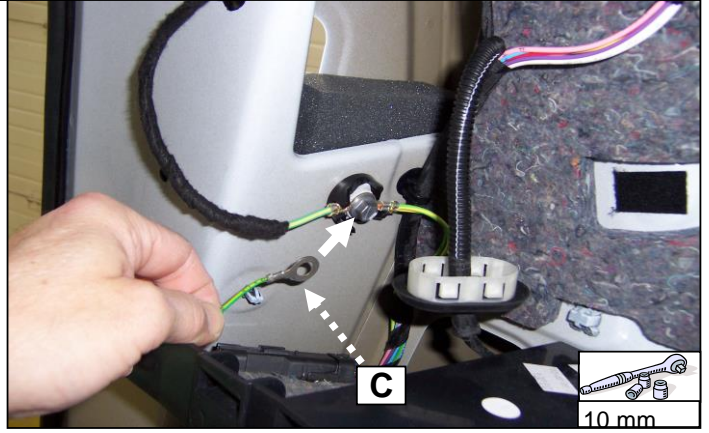

17

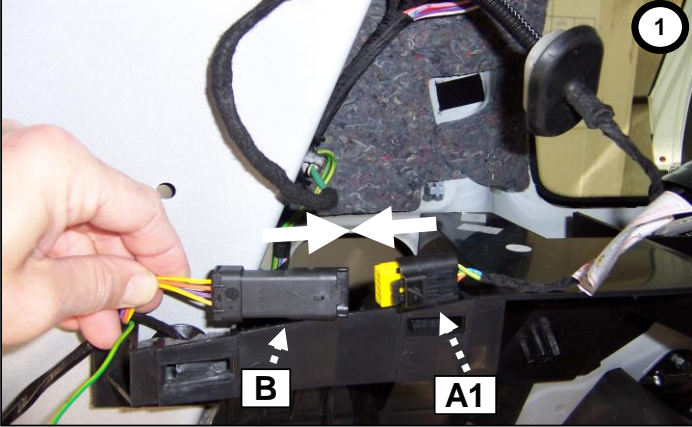

18

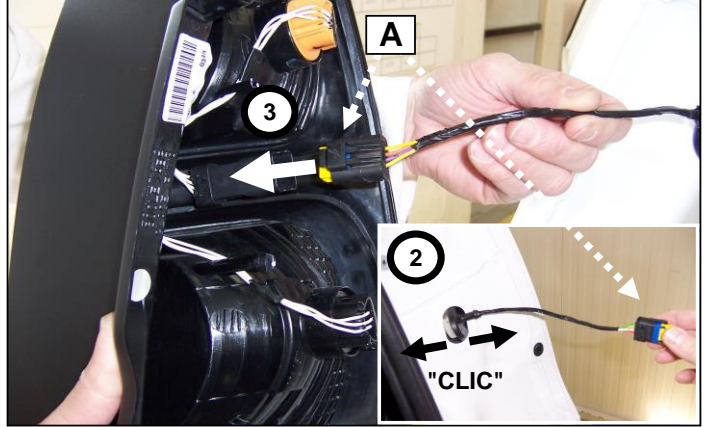

19

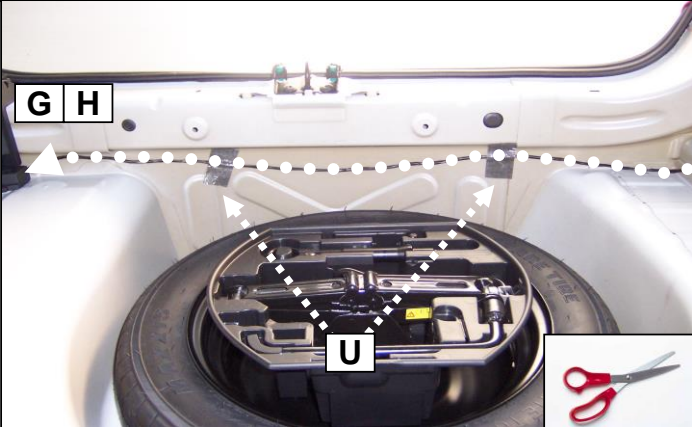

20

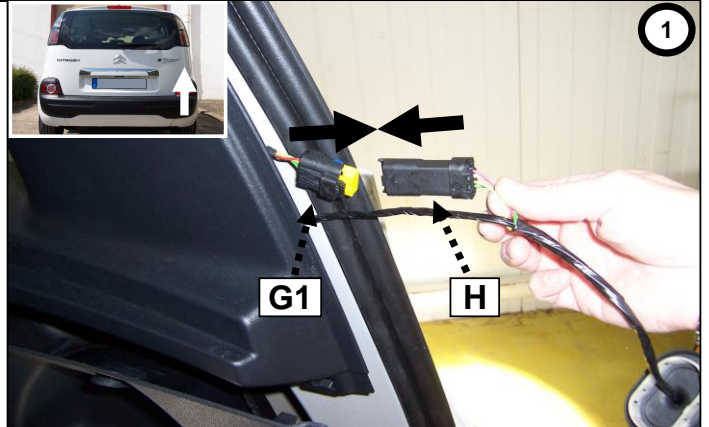

21

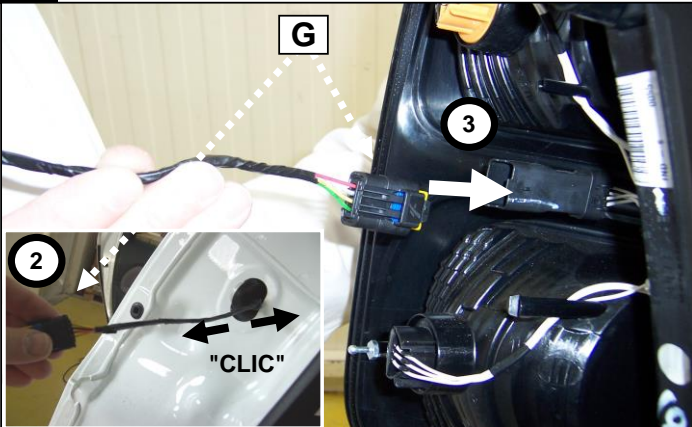

22

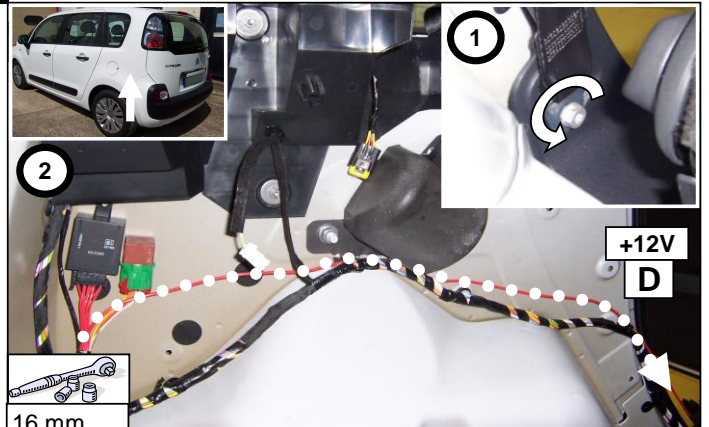

23



24



25

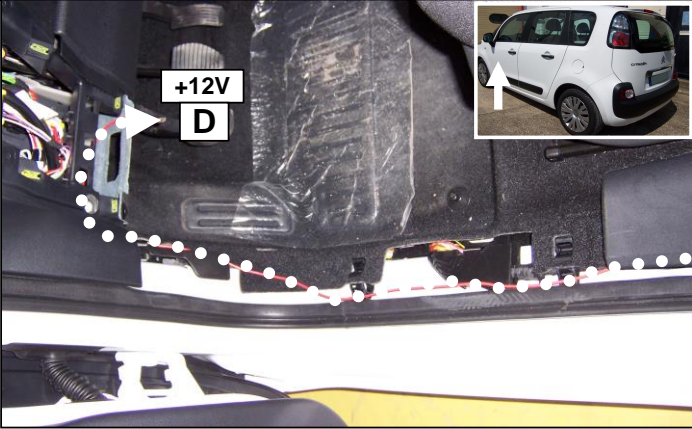

26

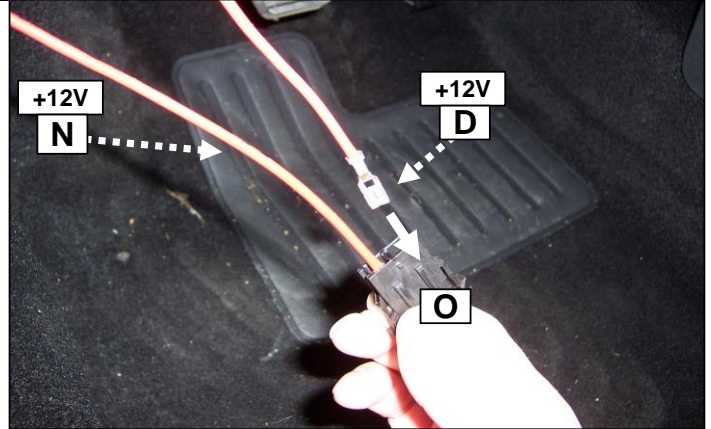

27

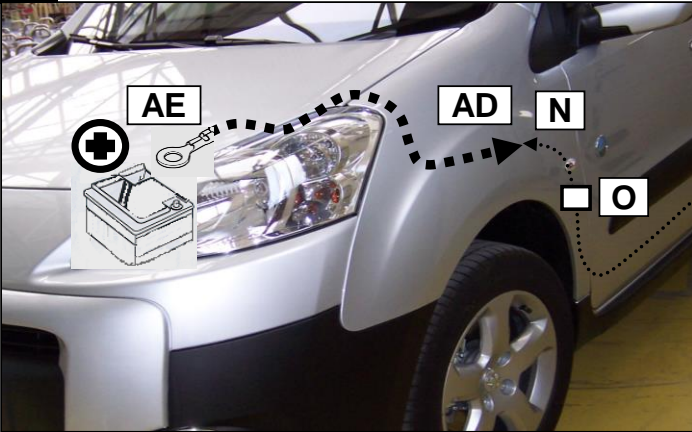

28

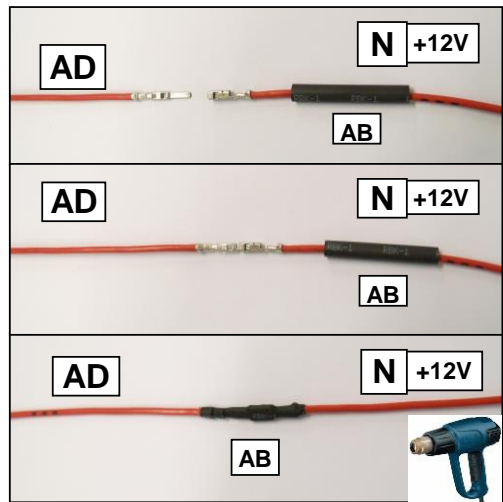

29

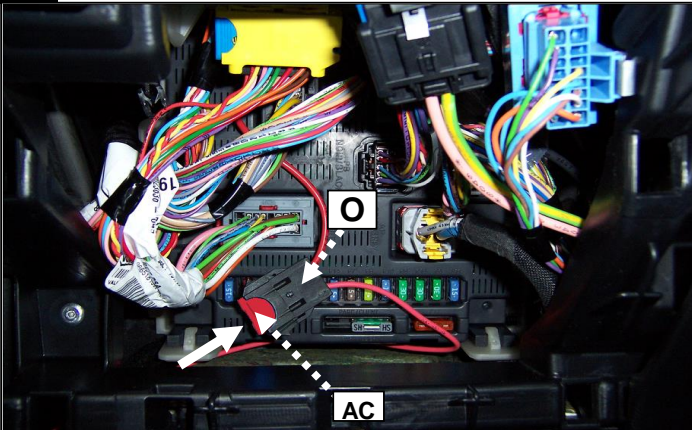

30

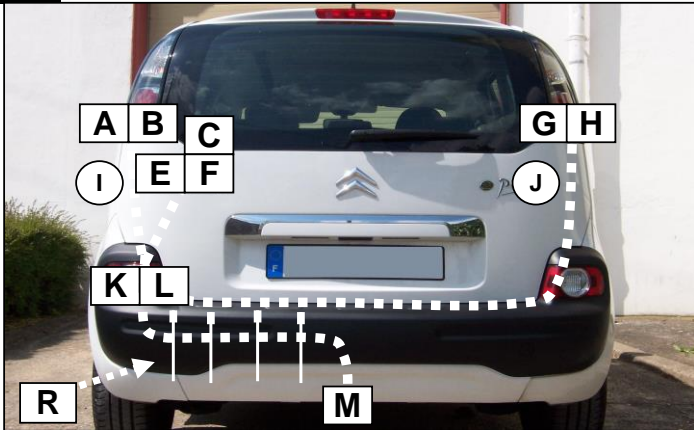

31



32

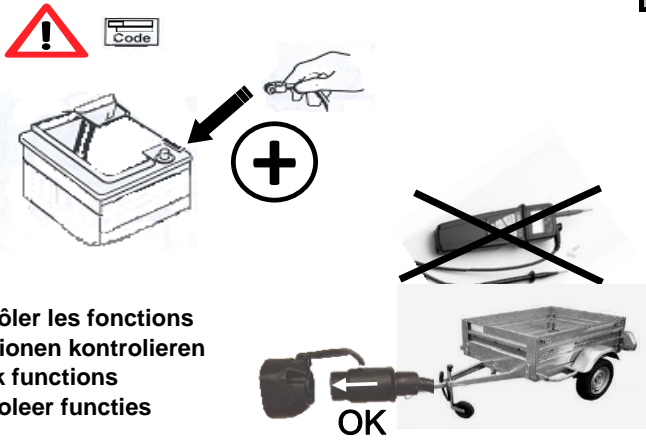

Contrôler les fonctions  
 Funktionen kontrollieren  
 Check functions  
 Controlear functies

33

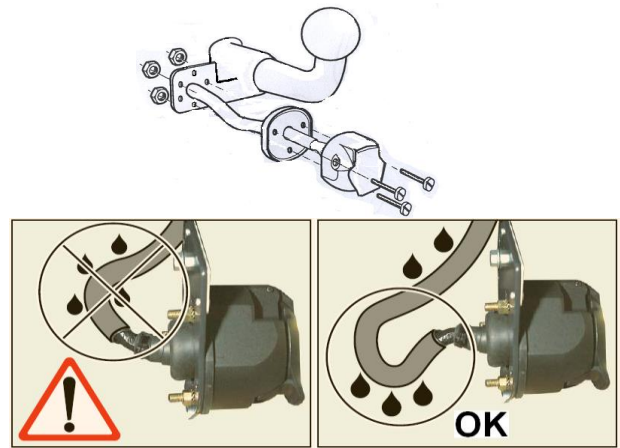

34



Lors du branchement de la remorque ,désactiver le système "RADAR DE RECUL" au tableau de bord  
 When you connect the trailer, do remove the function "PARK ASSIST" on the dashboard



